





# INSTRUCTIONS

## 1) GENERAL

TORLYS Uniclic® & Unifit-X® is a revolutionary system for installing floating floors without glue. Instead, it uses an ingenious tongue and groove system to “lock” the planks together. TORLYS Everest XP Elite, Designer and Designer Plus incorporates Unifit X® on the end joint to allow for drop down, angling or tapping installation. The length joint is the standard Uniclic® joint and is compatible with Unifit X®.

DROP DOWN  
REPLI

ANGLING  
INCLINAISON

INSERT HORIZONTALLY  
INSERTION HORIZONTALE

**IMPORTANT:** Use a hammer and the special TORLYS Tapping Block or TORLYS Bulldog™ tool. Never use any other tapping block, as it may damage the planks.

For a short edge, you can angle the plank into place, for example in the first row. Or you can drop down the joint to click it into place. Where you cannot angle or drop down the joint, you can engage it horizontally using a tapping block or Bulldog Tool. If tapping, use several small taps until the planks click together completely. For a long edge, angle-click the plank into place. If you cannot angle-click the planks (e.g. when installing final row), tap planks together gradually. Begin tapping lightly at the corner of a plank until the joint has clicked together. Repeat the process approximately every 12” (30 cm) until the entire long edge of the plank has clicked in with the next plank. Use a TORLYS “Last-Board Puller” or Bulldog™ tool to pull exposed joints tight, where a tapping block and hammer will not fit. Never attempt to knock the joint into place with one hit. For the best results, follow the installation instructions and use only:

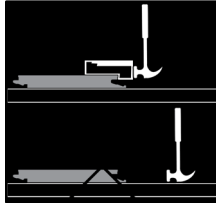

- A) TORLYS INSTALLATION KIT (Wedges, TORLYS tapping block and last-board puller)
- B) TORLYS MAINTENANCE PRODUCTS [TORLYS EcoCare (pH Neutral) Cleaner]
- C) TORLYS BULLDOG™ TOOL
- D) 6 MIL (0.15 MM) POLY VAPOUR BARRIER UNDER ALL FLOORS

## 2) CORRECT INSTALLATION

Wood is the primary component of your TORLYS Everest XP Elite, Designer and Designer Plus floor. Since the humidity of a room can vary from one season to the next, the floor must be able to expand and contract in ALL directions. A minimum of 1/2” (13 mm) expansion/contraction space must be provided at all walls and vertical obstructions (e.g. around pipes and at thresholds).

dZ Pu`À u`pYpZY[]}  
Z ZloUW òoX/vooZ ovlyZ  
u jYZ oYP òoUZ u jYV  
ZZZ oPZ(ooU(u) oYPoIX  
PlyvooYPZ (oBIZ o (Y IZ uX  
o`u u ZZ jYooZ  
(oYpYZ yPuyZ PÀ IZ  
fovl yPvoo jIP vPo v  
I yPuyZ ovlyZ PÀ jYoo ovIX  
tZP vo μP vo jYpuyZ  
ovlyX

## TRANSITION MOULDINGS

Installation cannot exceed 50’ (15 m) in any direction without installing a transition moulding (e.g. T-Moulding). Transition mouldings are also required in doorways less than 32” (81 cm).

**MATCH TRANSITION MOULDINGS** (e.g. Reducers)  
For the best appearance compare the transition mouldings and flooring before installation, identify the pieces that best match the mouldings for colour and grain, set them aside and then install them as needed.

Note: If using stair nosing in conjunction with this flooring, do not commence installation before referring to the stair nosing instructions. For details go to [www.torlys.com](http://www.torlys.com).

## 3) THE FIRST ROWS

À P μ v P X  
Z E d U v G E  
y X B O E  
(E d A X P μ  
y Z y P P y o Q V X  
K U Z E y Z (S  
U X D Y S  
u y μ y P P I E u b  
j P R X G d A  
Z P μ y P d o X  
G E y P d o  
v Z y G E  
u y μ μ I E u u P  
E o U d o o o  
ò μ v b j P μ E E  
X X

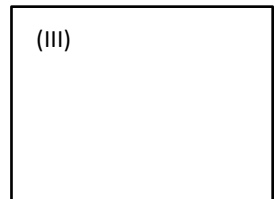

**IMPORTANT**  
Angle the end joint of the second plank into the end joint of the already laid plank. Click the two together. Ensure that the planks of the first row are straight (II). Repeat until the first row is complete.

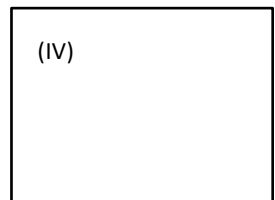

The cut piece from the first row becomes the starting piece for another row. Install the cut edge facing the wall, with the expansion wedge in place. Now angle this piece and click it into the first plank of the first row. The cut pieces should be a minimum of 15" (38 cm) in length (III).

Continue the second row with a full piece, placing the tongue of the long side into the groove of first row piece (IV).

Move the short end until it is pushed tight against the previous plank before it is lowered. Lower and click the plank into place. The plank must lock into the first row and the end joint must fit tightly into the previous plank. If the short edge is not fully engaged, use the tapping block and a number of smaller taps until the planks click into place completely. Do not attempt to knock the joint into place with one hit. Continue this method for each plank, covering the entire width of the room.

**PLEASE NOTE** that the stagger between the head joints should be 15" (38 cm) minimum, and preferably longer. Cut the last planks of each row leaving a minimum 1/2" (13 mm) gap to the wall.

#### 4) THE FINAL ROW

Measure and cut the planks of the final row so that there is a minimum 1/2" (13 mm) expansion/contraction space between the final row and the wall. These planks will be tapped into the last row using the **Last-Board Puller or Bulldog tool**. Drop down short edges, or tap together using TORLYS Tapping Block.

#### 5) UNDER DOOR FRAMES

Saw the planks so that after installation there is a minimum 1/2" (13 mm) expansion/contraction space. This expansion/contraction space can be covered by undercutting the door jamb. If you cannot rotate this plank, use the TORLYS Tapping Block and hammer to tap the planks together. TORLYS has designed a special tool for this type of installation: the TORLYS Bulldog™ tool.

#### 6) COMPLETING THE INSTALLATION – WATERPROOF\*

After installing your floor, you can immediately walk on it and begin the final touches. This is one of the major benefits of the glue-less system.

Remove any spacer wedges and, to create a waterproof seal around the entire perimeter, first fill all expansion spaces with compressible 1/2" (12 mm) PE foam backer rod (type Climashield or Climaloc); next, create a watertight seal by applying waterproof, flexible, 100% silicone sealant on top of the foam backer rod, covering at least 1/8" (3 mm) of the floor and 1" (2.5 cm) running up the wall (which will then be covered by baseboard, and quarter-round/ shoe mould, if required) or the door stop. Prior to installing the mouldings, first fasten the track to the subfloor, then apply the flexible silicone sealant along the portion of the moulding that will contact directly with the hardwood flooring surface.

Install mouldings and immediately wipe away any excess silicone sealant.

Apply flexible silicone sealant to door frames and trims or any other fixed objects.

Please see drawings below.

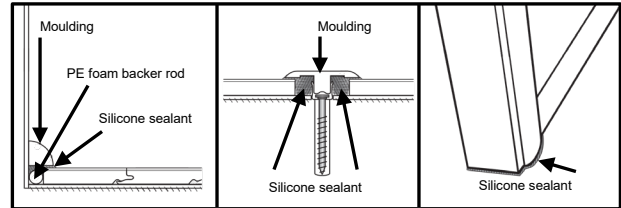

\*For **non-waterproof** installations, PE foam backer rod and silicone sealant are not required.

**IN BATHROOMS:** the use of a flexible silicone to seal the expansion and contraction space is mandatory in all bathroom installations.

#### 7) RADIANT HEAT APPLICATION

TORLYS Everest XP Elite, Designer and Designer Plus are guaranteed for installation over radiant-heated subfloors. For details and limitations, please check the "TORLYS Flooring Warranty and Instructions for installation over radiant-heated subfloors". Visit our website at: [www.torlys.com](http://www.torlys.com), for detailed information.

Visit our website at: [www.torlys.com](http://www.torlys.com) for detailed information.

#### ATTN: INSTALLERS – CAUTION: Wood Dust

Sawing, sanding and machining wood products can produce wood dust. Airborne wood dust can cause respiratory, skin and eye irritation. The International Agency for Research on Cancer (IARC) has classified wood dust as a nasal carcinogen in humans. **Precautionary Measures:** Power tools should be equipped with a dust collector. If high dust levels are encountered use an approved dust mask. Avoid dust contact with skin and eyes.

**Head Office:** TORLYS Inc.  
1900 Derry Road E., Mississauga, Ontario, L5S 1Y6 Canada  
[www.torlys.com](http://www.torlys.com)